

GT1800

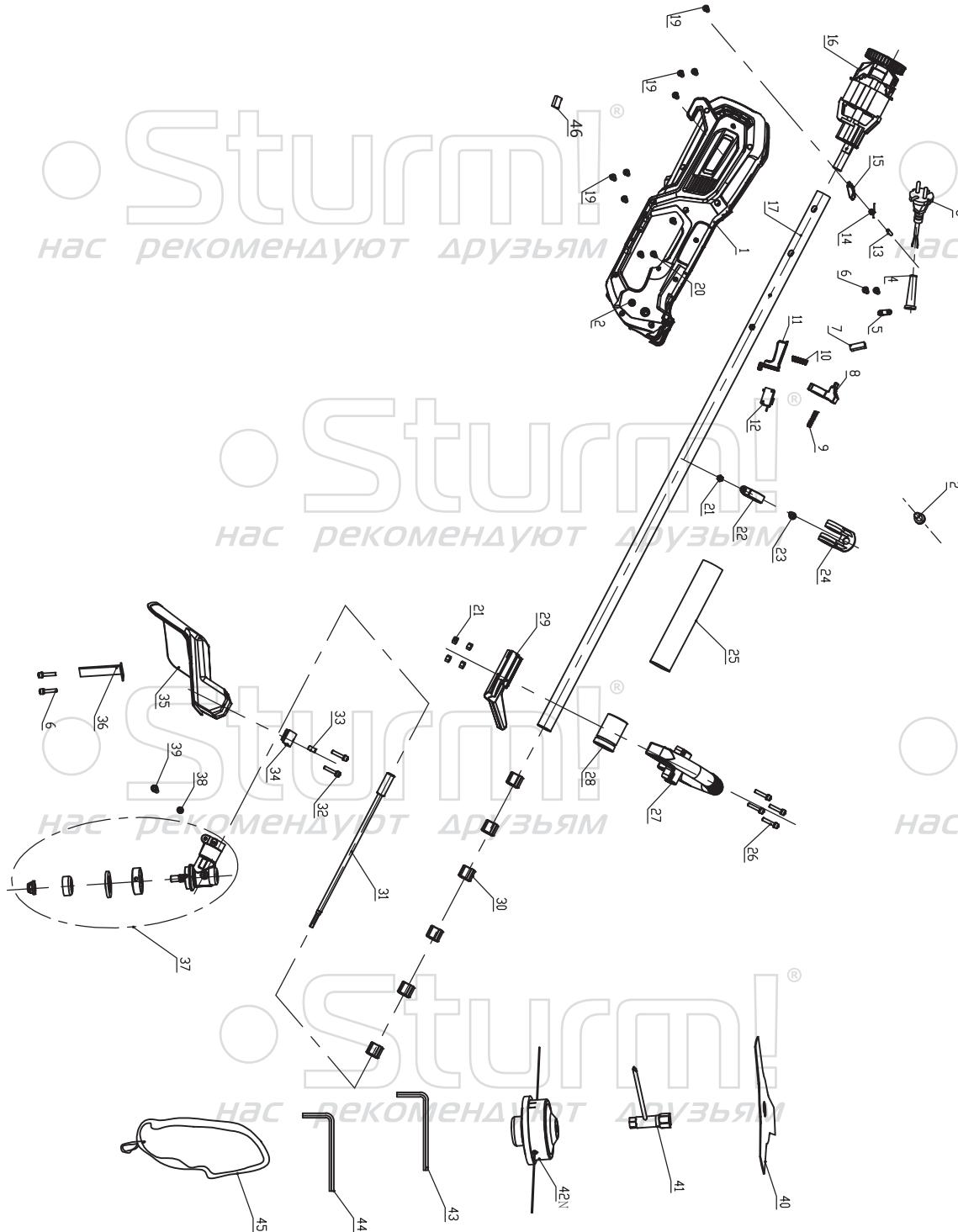

NO.	DESCRIPTION	SPEC
1	HOUSING	
2	SCREW	M5*14
3	CABLE	
4	CABLE PROTECTOR	
5	CABLE ANCHORAGE	
6	SCREW	ST4*12
7	CAPACITOR	
8	SAFETY LOCKING BUTTON	
9	SPRING 1	
10	SPRING 2	
11	SWITCH TRIGGER	
12	SWITCH	
13	PIN	∅ 4X40
14	TORSIONAL SPRING	
15	CABLE HOOK	
16	MOTOR ASSEMBLY	
17	STEEL TUBE ASSEMBLY	
19	SCREW	ST4*16
20	SCREW	ST3*12
21	NUT	M5
22	LIFTING RING FIXING RING	
23	SCREW	M5*16
24	LIFTING RING	
25	SPONGE TUBE	
26	SCREW	M5*30
27	UP HANDLE	
28	HANDLE FIXING RING	
29	DOWN HANDLE	
30	OIL BEARING	
31	HARD SHAFT	
32	SCREW	M6*25
33	RIVET	4X6
34	GUARD PRESS BOARD	
35	GUARD	
36	GUARD BLADE	
37	GEAR BOX ASSEMBLY	
38	SCREW	M5*12
39	SCREW	M5*25
40	THREE TEETH BLADE	
41	WRENCH	
42N	SPOOL	
43	HEX KEY S=5	
44	HEX KEY S=4	
45	STRAP	
46	SOFT STARTER	

GT1800-ex-RU250311